

Vishwa Cleanroom **Private limited**

Turnkey Projects for all cleanroom needs

WELCOME TO VISHWA CLEANROOM PRIVATE LIMITED!

Your foremost partner in healthcare solutions. With over a decade of industry

At Vishwa cleanroom Private limited is India's largest Manufacturing facility along with most advanced machinery and skilled manpower and certified like, GMP, ISO, Ce, CBRI, MSME, and many more.

With years of expertise, we deliver end-to-end Cleanroom solutions for pharmaceutical, hospital, chemical, and industrial projects—covering design, installation, and validation.

Committed to excellence and innovation, we strive to enhance healthcare standards, prioritizing both client satisfaction and environmental responsibility through energy-efficient technologies for a sustainable future.

We believe in Quality Product, delivery timelines and superior sites installation with zero tolerance policy as per our company tag line. With Vishwa Cleanroom we provide you a single window solution for all your cleanroom products needs.

Mission

Our expertise in healthcare industries, such as pharmaceutical manufacturing & hospitals, is to provide the right infrastructure to save lives & support essential work.

Vision

Our vision is to expand our services from India to a global scale, bringing our expertise and offerings to clients worldwide.

Core Value

Respect
Trust
Accountability
Collaborative
Teamwork

VISHWA CLEANROOM

We provide you a single window solution for all your cleanroom products needs

**Cleanroom PUF
Panels**

**SS/GI
Panels**

**HPL PUF
Panels**

**Air Shower
Booth**

**Cleanroom PUF
Ceiling**

**Cleanroom
Doors**

**Double Glass
View Panels**

**Biosafety
Cabinets**

**Emergency Exit
Doors**

**Fire/Sliding
Doors**

**Dynamic & Static
Pass Boxes**

**Laminar Airflow
System**

**Reverse Laminar
Airflow System**

**Hepa Filters
and Box**

**Pharma SS
Furniture's**

**Laboratory
Furniture**

01

Initial Assessment

Vishwa Cleanroom begins each project by analyzing spaces and planning system distribution to provide a customized quote that aligns with your budget and needs.



BRINGING IDEAS TO LIFE



02

Design Phase

Our technical team prepares a 3D layout that offers customers a realistic view of the entire project, giving them a clear preview of the result. This detailed visualization is essential for ensuring the design and installation phases stay on track.

INDUSTRY WE CATER TO

**Pharmaceutical
Manufacturing**



Hospital



**Aerospace
Industry**



**Solar Panel
Manufacturing**



**Semi Conductor
Manufacturing**

5



**Electronic Parts
Manufacturing**

6



**Food Processing
Manufacturing**

7



**EV and battery
Manufacturing**

8



CLEANROOM PANELS & CEILING



01

Pre-painted Galvanized
Iron (PPGI)

02

Powder-coated
Galvanized Iron (PCGI)

03

High-pressure
Laminate

04

Glass Panel Wall

05

Stainless Steel Wall &
Ceiling

06

Load Bearing
Ceiling

FEATURES

- Cost-effective & Removable & Re-locatable all panels
- Alternative To Conventional Construction Built To Drawing Layout, Minimal Alteration Required
- Fast And Easy Installation Pre-fabricated Cut-out
- For Utilities Flush Concept Highly Corrosive Resistance, Durable.
- Panel Thickness: 50mm/80mm/100mm/150mm
- Ceiling Thickness: 30mm/50mm Types: Walkable / Non-walkable

CLEANROOM DOORS

HPL Doors



**Powder
Coated Door**



**Stainless
Steel Door**



Glass Door

Fully Flush Surface With A Wall System A Large Variety Of Swing-out Doors
Manual/Semi-automatic & Fully Automatic Sliding Doors Best-in-class Door Hardware
Custom Dimensions Available Heavy-duty Structure For High Durability

FEATURES

- Powder-coated Galvanized Iron (PCGI) Doors
- High-pressure Laminate (HPL) Doors
- Glass Panel Door
- Stainless Steel Doors

FIRE & EMERGENCY EXIT DOOR

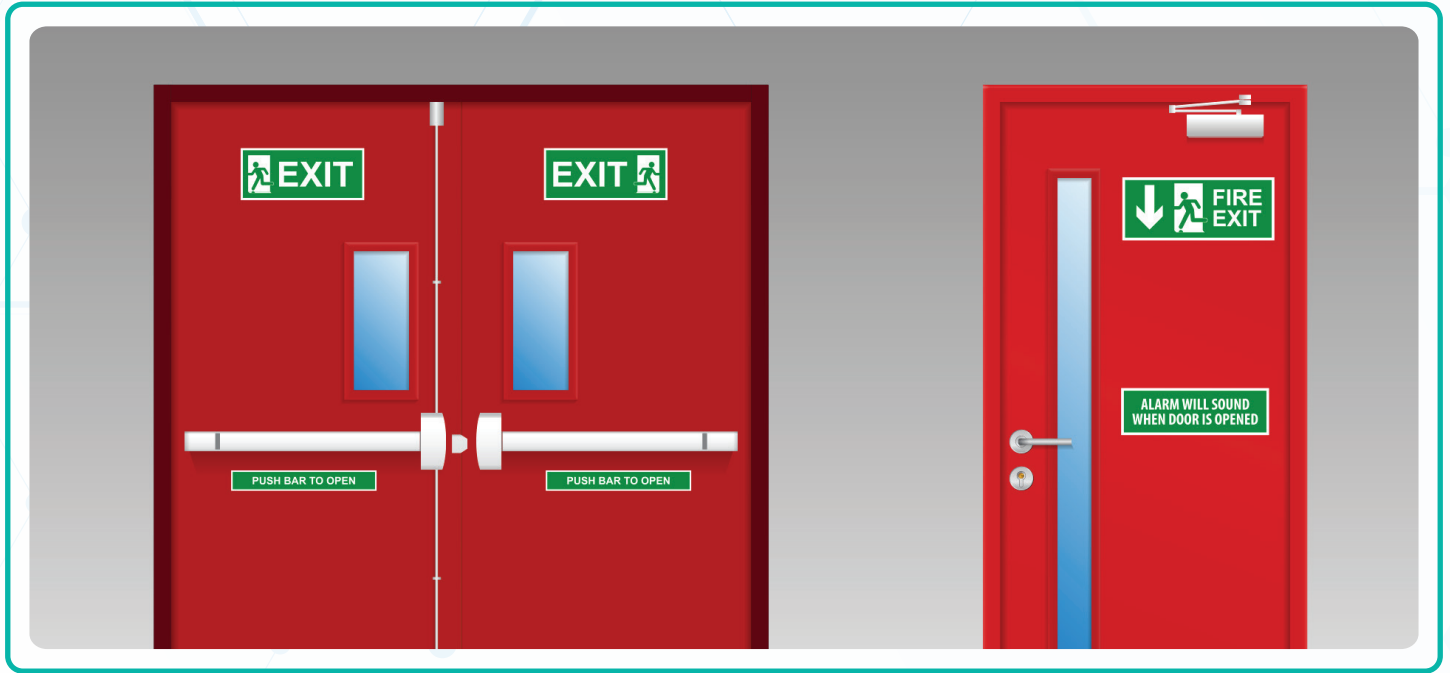

Commercial Doors



Industrial Doors

All door heavy duty & Multipurpose use for any application for any industrial uses
All fire doors are with fire rating certifications

Insulation Put(40Kg/M3),Rock Wool (96Kg/M3), PRI-Puff Fire Resistance Material
Airtight Construction: All doors Must Be Airtight To Prevent The Passage Of
Contaminants. This Is Achieved By Using Gaskets And Seals To Create A Tight
Connection Between The area.

CLEANROOM FURNITURES



01

All types of
Particulate Air Filters
for Air Handling Units

02

Activated
Charcoal/Gas
Phase Filters

03

UVPCO
Modules for Air
Purification

04

HEPA Boxes &
Hepa tents for
cleanroom

CLEAN ROOM FURNITURE

- Work Stations in SS Construction
- Post mortem Tables in SS Construction
- SS Trolleys in various designs
- Garment Storage Cabinets
- Clean Garment Storage Cabinets (with UV Sterilization lamp)
- Slotted angle racks in SS Construction
- Cross over bench
- Shoe rack for clean room applications
- Garment Discard Bin
- Stools and Chairs in SS Construction

CLEAN ROOM EQUIPMENT

- Static Pass Boxes
- Dynamic Pass Boxes
- Stand Mounted Laminar Flow Unit
- Mobile Laminar Air Flow Unit
- Ceiling Suspended Laminar Air Flow Unit
- Reverse Laminar Air Flow Unit
- Sampling Booth
- Dispensing Booth
- Air Shower

FOR HOSPITAL





For Hospital Entire modular operation theater ICU,Cath Lab IVF centre turnkey project services Along with Critical area development

LAB FURNITURES

All types of Chemical testing laboratory. Workplace turnkey projects



PRODUCT RANGE

- All Lab furnitures
- Fume Hoods
- HVAC System
- Biosafety cabinets
- Laminar air flow system
- Pass box
- Chemical Storage cabinets
- Sinks, taps and related accessories
- Animal House Equipment
- Individually Ventilated Caging System for rodents.
- Conventional Caging system for Rodents and rabbits
- Caging System for dogs and primates.
- Hen Isolators
- Metabolic Caging System for mice and rats.
- Bedding Disposal Stations for rodents
- Animal Change Stations for rodents
- Animal Enrichment Parts
- Trolleys in different designs
- Laboratory work tables
- Cabinets for work tables
- Work tops for work tables
- Overhead cabinets for work tables
- Sockets, switches and other electrical accessories
- Reagent Racks
- Electrical Raceways
- Vertical service pendants (Droppers)

OUR SERVICES

We provide entire chemical testing facility project Including Electrical,Hvac,Clean Room,Partition,Ceiling,Doors, and all services and utilities

CUSTOMER LIST

- AMI ORGANIC
- AJANTA PHARMA LIMITED
- ANUPAM RASAYAN INDIA LTD.
- ARKRAY HEALTHCARE
- AUSHADHI WELLNESS
- BASIC INTERNATIONAL
- BASIC PHARMA LIFESCIENCE
- CHEMOX PHARMA
- CHIRAL DRUGS
- DANOPHARM CHEMICALS
- K.PATEL PHYTO EXTRACTIONS
- KAD PHARMACEUTICA
- KENOOR ORGANICS
- KOHINOOR ORGANICS
- LILABA ANALYTICAL LABORATORIES
- MAXHEAL LABORATORIES
- NIRANJAN LABORATORY
- NUTRA CARE INTERNATIONAL
- PHARMAWIND HEALTHCARE
- RAJASTHAN HERBAL INTERNATIONAL
- REINE LIFESCIENCE
- SHREENEEL CHEMICALS
- SHRI MAHAABALI CHEM
- SOLIS PHARMACHEM
- STRUMED SOLUTIONS
- TRIO HEALTHCARE
- VAPI ORGANIC CHEMICALS
- APCOTEX INDUSTRIES LIMITED
- ATC TIRES
- WINGS HOSPITAL
- SPECTRUM ADVANCED EYE CARE

- GALAXY SURFACTANTS LIMITED
- GERRESHEIMER PHARMACEUTICAL
- GHCL LTD.
- GODREJ INDUSTRIES LTD.
- HINDUSTAN CHEMICAL
- ISHAN INDUSTRIES
- JAYSHREE AROMATICS
- KIRI INDUSTRIES LTD.
- MADHU SILICA
- RAMDEV CHEMICAL INDUSTRIES
- SHREE DARIYAV GLASSTECH
- SNEH SURGICAL
- SONANI JEWELS
- STERLING ACCURIS WELLNESS
- UPL LIMITED
- AASHIRWAD EYE HOSPITAL AND
PHACO SURGERY CENTRE
- ABHISHEK HOSPITAL
- AMRUTA HOSPITAL
- BIMS HOSPITAL
- BHARUCH ORTHOPEDIC HOSPITAL
- FORTUNE MEDICAL
- JANAK SMARAK HOSPITAL
- MARUTI HEALTHCARE
- MEHTA HOSPITAL
- MAANIT NEURO CARE
- PORBANDAR CRITICAL CARE LLP.
- PRIME HOSPITAL
- RUDRAKSH ORTHOPEDIC HOSPITAL
- SHREE ORTHOPEDIC HOSPITAL
- SIDS HEALTH CARE

** The above all customers are our existing sister-concern company customer.

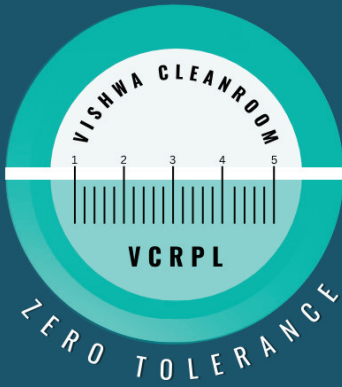

Register Address

Plot no A-1 Sudama industrial estate
Gidc Ankleshwar 393002

Factory Address

Plot No 2900/2 Near Atul limited,Gidc
Ankleshwar 393002



6359555939 | 6359555944



info@vcrpl.com | sales@vcrpl.com



www.vcrpl.Com